



VPL-3100 **Operator's Manual**

Technical Service email: service@bruno.com
www.bruno.com

1780 EXECUTIVE DR., P.O. BOX 84, OCONOMOWOC, WI 53066 USA
TELEPHONE: (262) 567-4990
FAX: (262) 953-5501
1-800-882-8183

REV. 11-13-2006

Thank you for purchasing a Bruno VPL-3100 Vertical Platform Lift.



The information contained in this manual is provided with your safety in mind. Please read and follow the instructions to ensure safe and trouble-free operation.

Throughout this manual, ***safety precautions*** may be provided to identify potentially hazardous situations and to advise how to avoid them.



Warning—Indicates a potentially hazardous situation that, if not avoided, could cause serious bodily injury and / or property damage.



Caution—Indicates a potentially hazardous situation that, if not avoided, could cause damage to the lift, vehicle and / or moderate injury.



Electrical Hazard—Indicates a potentially hazardous electrical situation that, if not avoided, could cause damage to the lift, vehicle and / or moderate injury.

TABLE OF CONTENTS

Safety	4
Product Registration Form	5
Specifications	6
Operation Instructions	7
Operating in Cold Weather	8
Emergency Operation	9-10
Maintenance and Troubleshooting	11
Warranty	12-13

FOR YOUR SAFETY

- Never exceed the maximum rated lift capacity of 750 lbs. (340 kg).



- Read and understand the operating instructions, and all safety precautions prior to using the lift. Operate the lift several times while the installer is available to answer questions.
- Never use the VPL-3100 to lift freight or materials other than those intended by design.
- Keep panels and protective coverings in place to avoid potentially fatal injury.
- Do not open the lift's electrical box. ***There are no user-serviceable parts in the electrical box.***
- Always be aware of surface conditions before using the lift and take appropriate care.
- Keep hands, fingers and feet away from moving components during lift operation.
- Keep feet at a safe distance from the platform as it is lowered.
- Turn the power source of the device being lifted (scooter, power chair, wheelchair) to ***OFF*** before operating the lift.
- Lock the wheels of any mobility device riding on the platform.

PRODUCT REGISTRATION FORM

 **Product Registration Form**
Please print in CAPITAL letters.

! Please be assured that Bruno **does not** share or sell the information you provide.

Last Name _____
First Name _____ M.I. _____
Street Address _____
City _____ State _____
Zip/Postal Code/Country _____
Email Address _____
Telephone No. _____
Date of Purchase (mm/dd/yy) _____

Serial No. _____
Bruno product information here.
Model No. _____

Installer (if different than seller) _____

Where did you hear about Bruno? CHECK ALL THAT APPLY.

doctor/therapist
 Bruno dealer
 AARP publication
 Internet
 local newspaper
 radio
 other (please tell us): _____

Who was the primary decision maker for this purchase?

user of product
 family member
 friend
 care giver
 doctor/health care provider

Which of the following health issues are of concern to you? CHECK ALL THAT APPLY.

spinal injury
 arthritis
 diabetes
 stroke
 post polio
 muscular dystrophy
 multiple sclerosis
 emphysema
 other (please tell us): _____

Please rate your satisfaction with your Bruno dealer:
 excellent good average poor

Please rate your satisfaction with your Bruno product:
 excellent good average poor

Bruno reserves the right to use comments indicated on this form in its on-line, video, audio and printed materials. Names will be abbreviated to ensure the privacy and anonymity of the individual.

©2006,2005 Bruno Independent Living Aids, Inc.® Rev. 10/06

Bruno is pleased to provide you with this independence-enhancing product.

The Product Registration Form is shipped in a plastic bag with this manual. It is very important that you fill out and return this form at your earliest convenience so that we may complete the warranty registration process for your unit.

The **serial number** is found on labels affixed to the manual, as well as on the unit itself.

Serial and model numbers must be provided when filing a warranty claim, requesting service or ordering parts. We encourage you to keep this information readily available at all times.

Please Note: The warranty for the VPL-3100 Stairway Elevator is *rendered null and void* if the unit is installed by anyone other than an authorized Bruno dealer.

Best wishes from the Bruno Team.

SPECIFICATIONS

<i>Load Capacity</i>	750 lbs. (340 kg)
<i>Weight of Unit</i>	
<i>VPL-3153</i>	752 lbs. (341 kg)
<i>VPL-3175</i>	825 (374 kg)
<i>Rated Speed</i>	9 FPM (2.75 m/mn)
<i>Power Supply</i>	120 VAC, 15A, single phase, 60 Hz
<i>Motor</i>	1 HP, 120 VAC
<i>Control Voltage</i>	24 VAC, motor 120 VAC
<i>Maximum Travel</i>	53" (1.3 m) unit and 75" (1.9 m) unit
<i>Platform Size</i>	standard: 34" x 48" (86 x 122 cm); optional: 34" x 54" (86 x 137 cm)
<i>Emergency Operation</i>	provision for manual hand wheel
<i>Standard Features</i>	keyed, constant-pressure controls on platform with emergency stop switch; all-weather protected controls and switches; platform bottom safety panel, top and bottom limit switches, automatic folding ramp
<i>Optional Features</i>	landing call/send station with key; top landing gate including call/send station with key and Bruno interlock; 34"x54" non-skid platform

OPERATING INSTRUCTIONS



Releasing the call/send button at any time will stop the lift.



When the VPL is not in use, Bruno recommends raising the unit off the ground to approximately the mid-travel position.

This will discourage unwanted use by others and, in colder climates, prevent the underpanel from becoming frozen in accumulated ice/snow.

1. Open the landing gate (if applicable).
2. Move onto the platform.
3. Lock the wheels of the mobility device (if applicable).
NOTE: Wheels of mobility devices on board the VPL-3100 must remain locked while the VPL-3100 is in operation.
4. Insert the key into the call/send switch.
5. Turn the key to the ON position.
6. Press the *top* button to go *UP*. Continue pressing until the platform automatically stops at the top landing.
7. Press the *bottom* button to go *DOWN*. Continue pressing until the platform automatically stops at the bottom landing.
8. Release the button.
9. Turn the key to the OFF position.
10. Remove the key from the call/send switch.
11. Exit the lift.

OPERATING IN COLD WEATHER

If the temperature falls below 0° F (-18° C):

1. Park the platform in a raised position, approximately mid-way up the tower.
2. When ready to operate the unit, check for the presence of accumulated ice or snow on the control buttons and underpan. Remove ice/snow before operating the lift.
3. Run the lift ***down***, then all the way up, then to the desired level to board the platform.

This will warm up the nut and screw mechanism to allow proper operation of the lift.

EMERGENCY OPERATION

Bruno offers an optional hand wheel for the VPL-3100 to serve in case of a power failure or non-operation.

If your lift is not equipped with a hand wheel and you would like to order one, please contact an authorized Bruno dealer. Contact a dealer as well if you require assistance in operating the hand wheel.

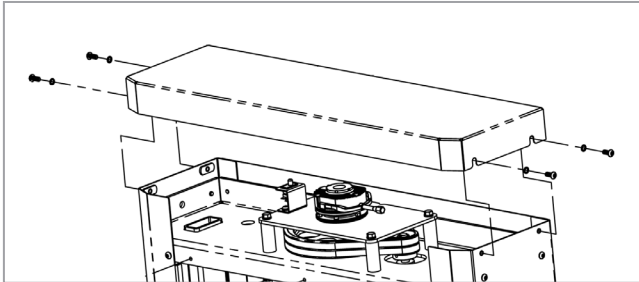

Using the hand wheel

1. Loosen the (2) screws on each side of the *top cover (see left)*.
2. Slide the *top cover* up and off.
3. Locate the emergency hand wheel on top of the lift.

EMERGENCY OPERATION

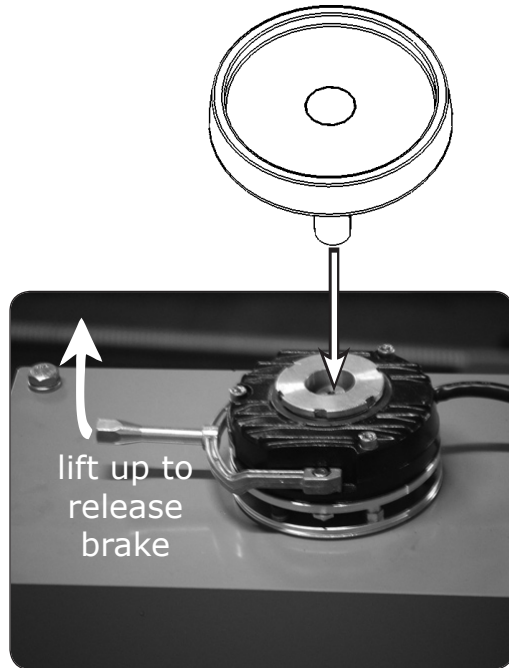

4. Insert the hand wheel into the brake shaft opening as shown.
5. Release the brake by lifting up on its release lever (see left).
6. Continue to hold up the brake release lever as you turn the hand wheel counterclockwise to lower the lift.
7. After safe exit of the passenger and mobility device, determine and remedy the cause of the incorrect operation. Contact an authorized Bruno dealer if you require assistance.
8. Lower the brake release lever to re-engage the brake.
9. Remove and store the emergency hand wheel.
10. Reinstall the top tower cover and secure using the (4) screws shown on the previous page.

MAINTENANCE AND TROUBLESHOOTING

Once a year (more frequently if the lift is used under strenuous conditions), have the lift undergo a complete inspection by an authorized Bruno dealer and any necessary repairs/replacements. ***Having the VPL-3100 serviced by someone other than an authorized Bruno dealer will render your warranty null and void.***

<i>PROBLEM</i>	<i>POSSIBLE CAUSE / SOLUTION</i>
Platform does not operate properly in the UP or the DOWN direction.	<ul style="list-style-type: none">• Gate/door open. Close gate/door.• E-Stop button inadvertently depressed. Pull out E-stop button.
Platform controls do not operate.	<ul style="list-style-type: none">• Key switch turned to OFF. Turn key to ON.• E-Stop button inadvertently depressed. Pull out E-stop button.• Power cord unplugged. Plug in cord.

2 & 1 BRUNO GOLD LIMITED WARRANTY 2 Years Major Components — 1 Year Parts for Bruno Vertical Platform Lift

Bruno Independent Living Aids, Inc. ("Bruno"), warrants to the original purchaser of a Bruno Vertical Platform Lift that the Bruno Vertical Platform Lift is free from defects in material and workmanship for a period of one year from date of purchase. In addition, Bruno warrants that the motor, Acme screw and drive nut, brake, pulleys, belt and screw bearings (the "Major Components") will be free from defects in materials and workmanship for a period of two years from the date of purchase.

The exclusive remedy for a defect in a Bruno Vertical Platform Lift shall be the repair or replacement, at the option of Bruno, of the defective part or component. After the first 30 days of this warranty, only parts and components are covered. This warranty does not cover labor and other services after the initial 30 days. If repair or replacement of a Bruno Vertical Platform Lift is not commercially practical or cannot be timely made, Bruno may elect to refund the purchase price of the Bruno Vertical Platform Lift instead of repairing or replacing the Bruno Vertical Platform Lift.

IN NO EVENT SHALL BRUNO BE RESPONSIBLE FOR INDIRECT, INCIDENTAL OR CONSEQUENTIAL DAMAGES, WHETHER SUCH DAMAGES ARISE FROM CLAIMS BASED ON CONTRACT, WARRANTY, TORT (INCLUDING NEGLIGENCE), STRICT LIABILITY OR PRODUCT LIABILITY. Some states do not allow the exclusion or limitation of incidental or consequential damages, so the above limitation or exclusion may not apply to you.

ALL IMPLIED WARRANTIES, INCLUDING ANY WARRANTY OF MERCHANTABILITY OR FITNESS FOR A PARTICULAR PURPOSE, ARE LIMITED IN THEIR DURATION TO THE LENGTH OF THE WARRANTY STATED ABOVE FOR THE AFFECTED COMPONENT. Some states do not allow limitations on how long an implied warranty lasts so the above limitation may not apply to you.

To obtain warranty service, you must follow these procedures:

1. Obtain return authorization by calling your local Bruno dealer;
2. Return the Bruno Vertical Platform Lift, freight prepaid, to the address provided by your Bruno dealer or Bruno with proof of purchase indicating the date purchased.

Bruno will pay for shipping back to the purchaser within the continental United States and Canada if a defect in material or workmanship is discovered. Return freight and repair charges will be the responsibility of the purchaser if the problem is not covered by warranty.

This warranty does not cover damage or failure caused by misuse, abuse, accidents, physical damage, modifications not made by Bruno, damage in shipment, or repairs undertaken by anyone other than Bruno factory employees or authorized distributors. The "original purchaser" of a Bruno Vertical Platform Lift that is leased or rented shall be the person or entity acting as the lessee or rental provider.

This warranty gives you specific legal rights, and you may also have other rights which vary from state to state. Bruno specifically does not authorize any person to extend the time or scope of this warranty.

For further information regarding this limited warranty, please contact Bruno by calling 1-800-882-8183 or writing to Bruno at the following address:

Bruno Independent Living Aids, Inc.
Attention: Service Department
1780 Executive Drive, P.O. Box 84
Oconomowoc, WI 53066 USA

First in Performance. Built to Last!

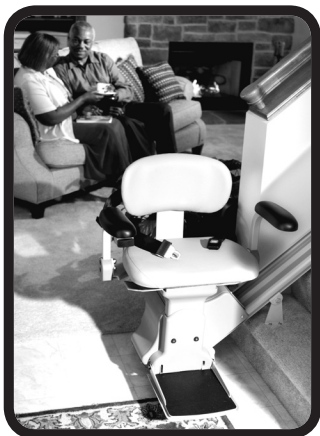

**Straight & Custom
Curved-Rail Stairlifts**



Vertical Platform Lift



**Over 25 Different
Vehicle Lift Solutions**



Turning Automotive Seating

Bruno Independent Living Aids, Inc.[®]

1780 Executive Drive, P.O. Box 84, Oconomowoc, WI 53066

262-567-4990 • FAX: 262-953-5501 • www.bruno.com

 **BRUNO[™]**
for your independence

©2006 Bruno Independent Living Aids, Inc.[®] All illustrations and specifications in this brochure are based on the latest product information available at the time of publication. Bruno Independent Living Aids, Inc.[®] reserves the right to make changes at any time without notice. Manual Back Cover 8/06-2.

P/N 3100 O